

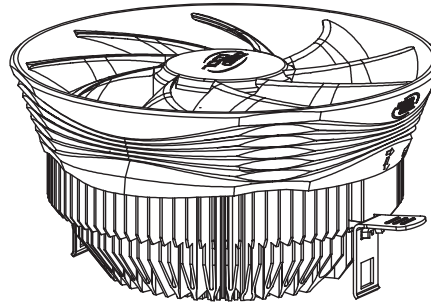

INSTALLATION GUIDE

This installation guide is applicable for GAMMA BLADE series.



GAMMA BLADE

PRODUCT SCHEMATIC DRAWING

CAUTION:

1. All specifications subject to change without notice.
2. Under no condition shall Deepcool be liable for any indirect, incidental or consequential damages arising from any defect or error in this manual or product.
3. Please ask for professional help if you are not sure of safe installation.
4. Installation manual in other languages is available on our website: www.deepcoolglobal.com

Appearance Patent NO.: 201130216036.0
 Package Patent NO.: 201130216433.8
 Brands and designs are trademarks from Beijing Deepcool Industries Co., Ltd.
 Devices not included.
 All rights reserved.

Beijing Deepcool Industries Co., Ltd.
www.deepcoolglobal.com

MADE IN CHINA

COMPONENTS LIST

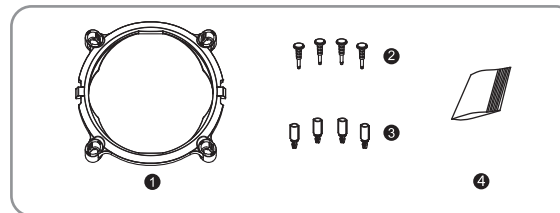

- | | |
|--------------------|------|
| ① Mounting Bracket | 1pc |
| ② Push-pin | 4pcs |
| ③ Clip | 4pcs |
| ④ Thermal Grease | 1pc |

INTEL LGA1156/1155/775 Installation

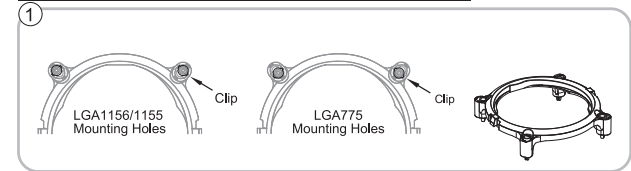

As illustrated, insert the clips into the mounting bracket according to the socket type.

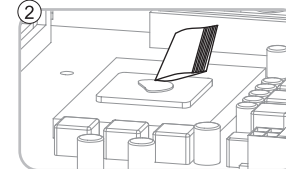

Evenly apply a thin layer of thermal grease onto the processor.

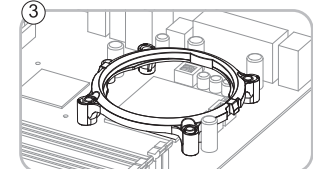

Put the mounting bracket on the motherboard with the clips in the motherboard mounting holes.

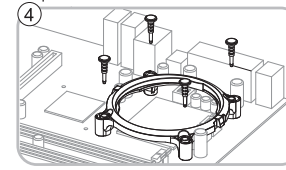

Insert the push-pins into the clips, push them tight until the mounting brackets are safely installed on the motherboard.

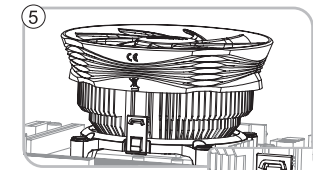

As illustrated, put the heatsink onto the processor and hook the vertical clip onto the retention frame tab.

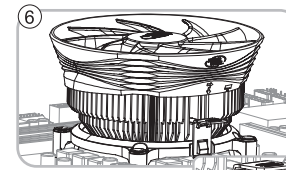

Press down the other side clip and secure the heatsink. Please ensure perfect contact between the heatsink base and the CPU surface during installation.

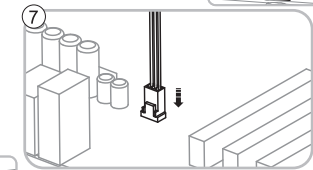

Finish the installation by connecting the fan cable to the motherboard.

AMD AM3/AM2+/AM2/K8 Installation

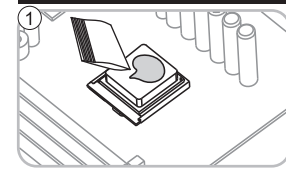

Evenly apply a thin layer of thermal grease onto the processor.

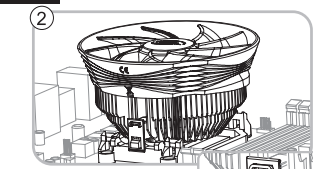

As illustrated, put the heatsink onto the processor and hook the vertical clip onto the retention frame tab.

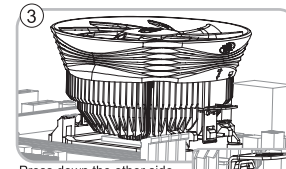

Press down the other side clip and secure the heatsink. Please ensure perfect contact between the heatsink base and the CPU surface during installation.

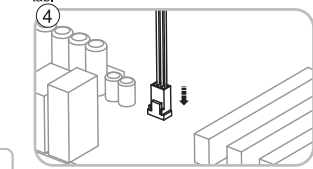

Finish the installation by connecting the fan cable to the motherboard.